

Product features

Broadband, low loss.

Main specifications

Parameters	Min	Typical	Max	Units
Frequency	1200	~	2500	MHz
IL			1	dB
Isolation	20			dB
Main line VSWR			1.5	
feed-voltage		28		V
Feed current		1000		mA

Other parameters

Connector	TNC-K detachable
Impedance	50Ω
Power	40W RF Power
Shell Material	Aluminium
Work Temp.	-40~+85°C Design assurance

Port Definition

RF port	RF
RF&DC Port	RF&DC
DC Port	DC

Reference picture



Configuration(mm)

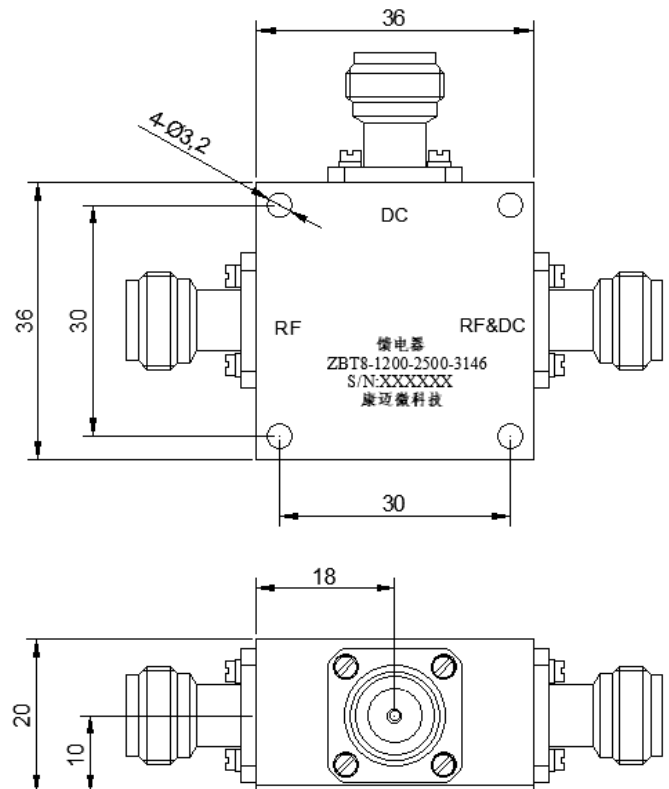

Note

1	Please do not wash the product in the cleaning solution.,Please do not wash the product in the cleaning solution.
2	If the temperature is higher than 125°C, consult with us before ordering.